



Expanded Cork External Wall Insulation - Quick Application Guide

TO BE READ IN CONJUNCTION WITH FULL APPLICATION GUIDE, MATERIAL TECHNICAL DATA SHEETS AND MATERIAL SAFETY DATA SHEETS WHERE APPLICABLE - See www.lime.org.uk for all TDS & MSDS.

1 Preparation

IMPORTANT: Protect your eyes with safety glasses (ones with sides) and keep eyewash close to hand!



Tip: Lime is caustic and can seriously damage eyes. Goggles are essential at all stages.

2

IMPORTANT: Wear gloves and cover skin. Lime burns are gradual (i.e. you don't feel them at the time) but can be very serious so PPE is essential.



Tip: Thin, disposable gloves are easiest to work with.

3

Remove and loose any crumbling material. Particularly any cementitious or gypsum based materials

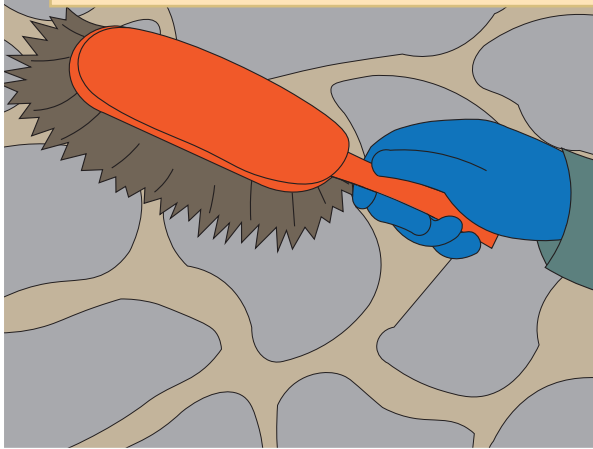

4 Application

Thoroughly dampen the surface before applying the levelling coat of bedding mortar (to ensure moisture isn't absorbed too rapidly.)

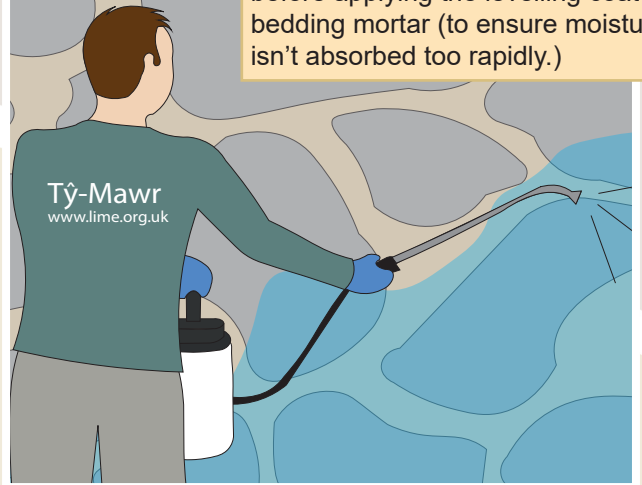

5

Apply levelling coat of fibred NHL3.5 plaster in even coats of 10mm.

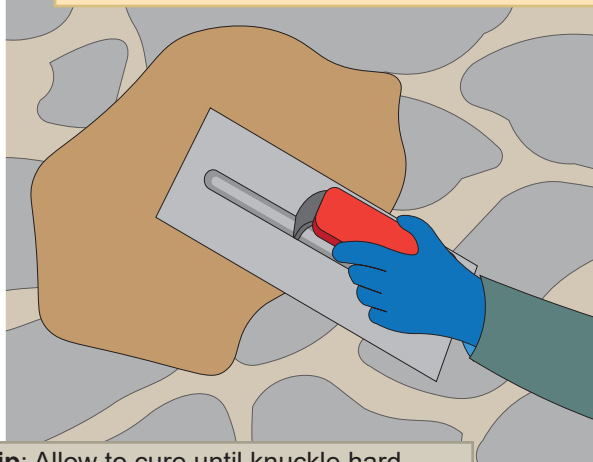

Tip: Allow to cure until knuckle hard.

6

Apply a combed coat of **Secil Tek Isovit E-Cork** Adhesive Mortar with 10mm notched trowel.

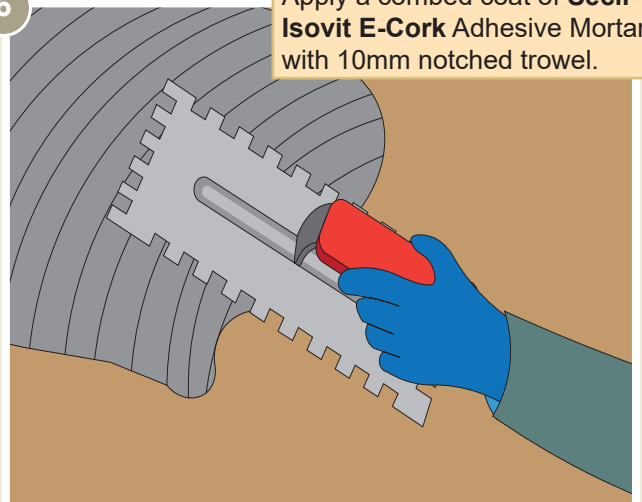



Expanded Cork External Wall Insulation - Quick Application Guide

TO BE READ IN CONJUNCTION WITH FULL APPLICATION GUIDE, MATERIAL TECHNICAL DATA SHEETS AND MATERIAL SAFETY DATA SHEETS WHERE APPLICABLE - See www.lime.org.uk for all TDS & MSDS.

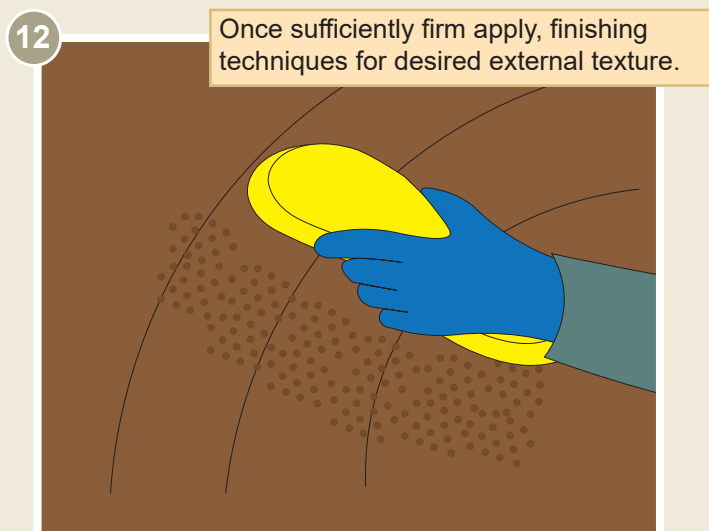
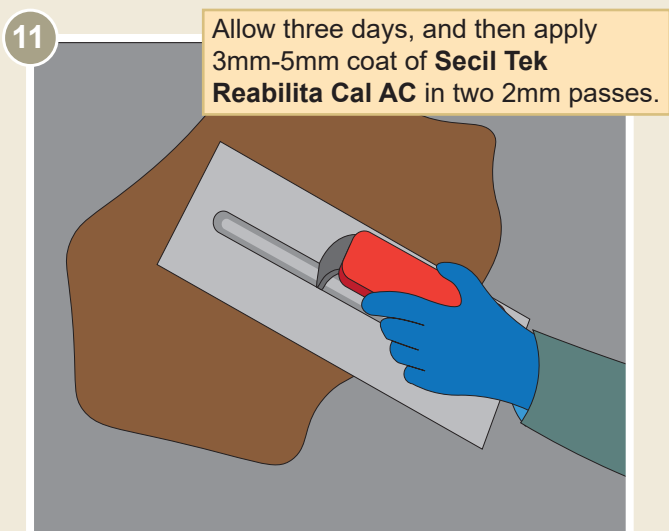
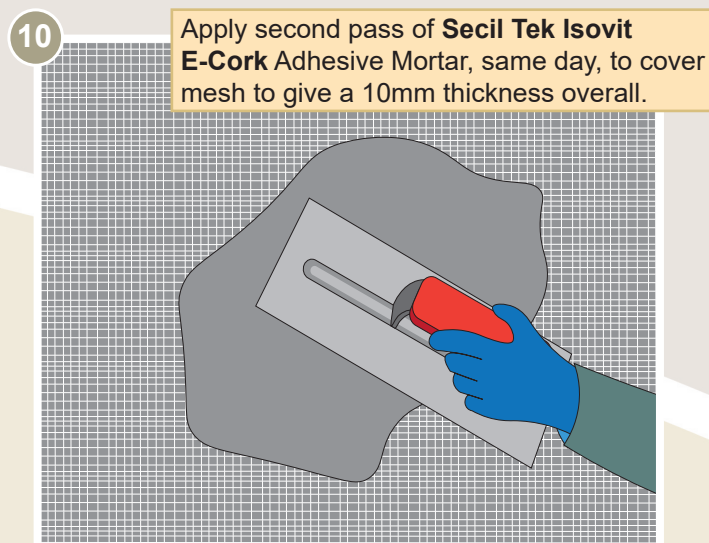
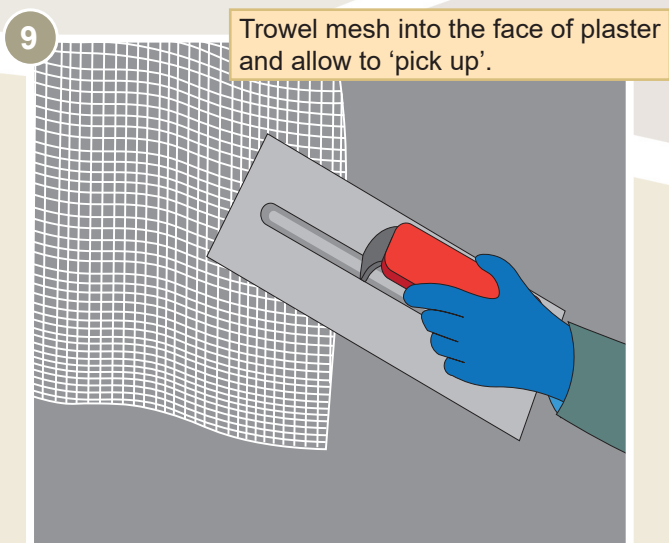
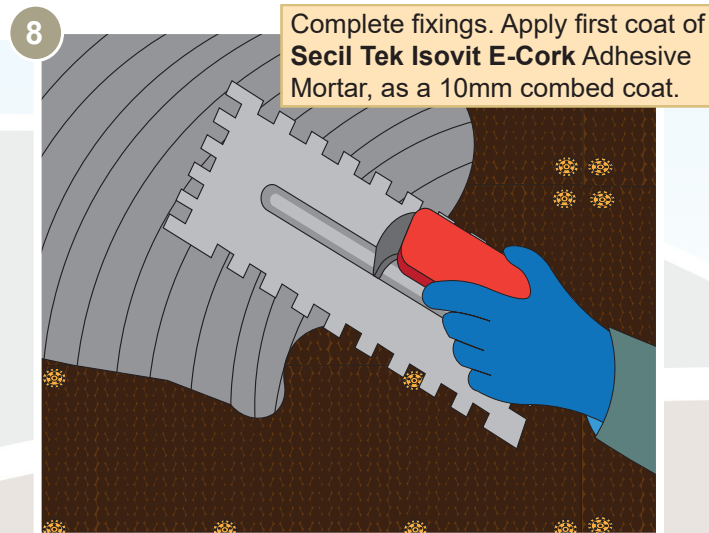
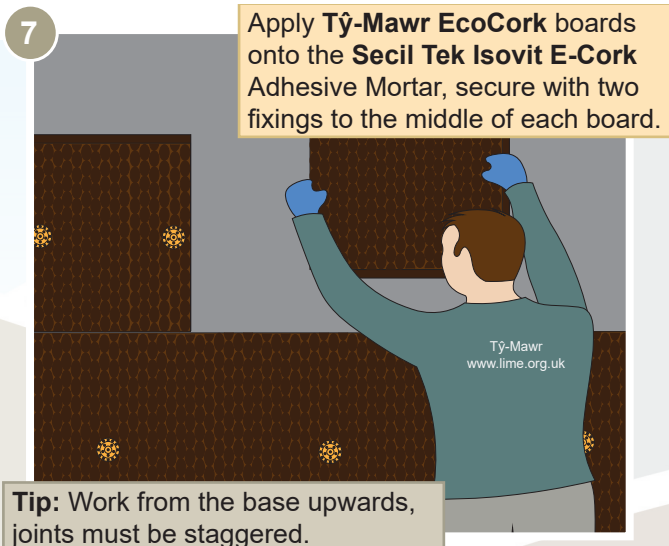



Tÿ-Mawr

www.lime.org.uk

sustainable building materials
for healthier homes

Expanded Cork External Wall Insulation - Quick Application Guide

TO BE READ IN CONJUNCTION WITH FULL APPLICATION GUIDE, MATERIAL TECHNICAL DATA SHEETS AND MATERIAL SAFETY DATA SHEETS WHERE APPLICABLE - See www.lime.org.uk for all TDS & MSDS.

14

After 30 days, apply a breathable paint such as **Beeck's Renosil** or **Graphenstone Biosphere/GCS** - See below!

Summary

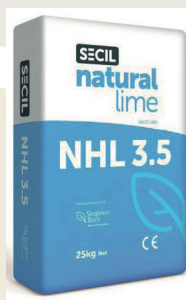
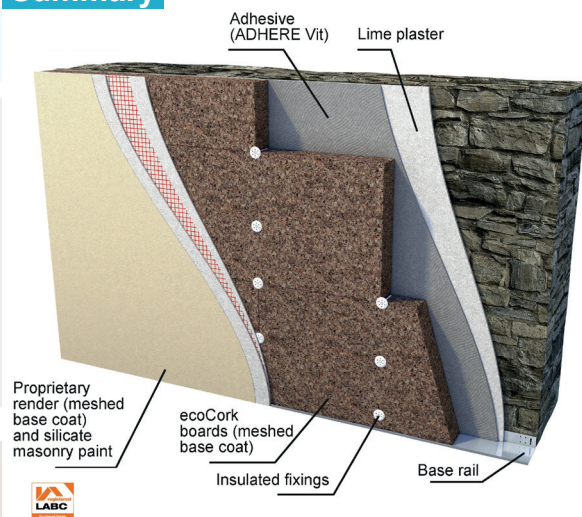

The application of lime plaster is more involved than using conventional plaster. It is highly recommended to use a builder experienced in the use of lime plaster or at the very least you should get some practical experience e.g. on a course, as it is not possible to cover every point in detail here. However, if you need further guidance after following the advice given, please contact our Product Support Team at tymawr@lime.org.uk or 01874 611 350.

Available Paint Finishes



Graphenstone Biosphere



Graphenstone GCS



Beeck's Renosil



Expanded Cork External Wall Insulation - Quick Application Guide

TO BE READ IN CONJUNCTION WITH FULL APPLICATION GUIDE, MATERIAL TECHNICAL DATA SHEETS AND MATERIAL SAFETY DATA SHEETS WHERE APPLICABLE - See www.lime.org.uk for all TDS & MSDS.

Common Mistakes/ Troubleshooting

If you are experiencing problems (cracking, crumbling, dusting, failure) - please refer to our trouble shooting section on the website www.lime.org.uk for possible causes and preventative and remedial actions.

Approximate Coverage Rates

Secil Tek Isovit E-Cork - A 20kg bag will cover 6m² at 6mm thick

Secil Tek Reabilita Cal AC - 25kg bag will cover 7m² at 3mm

Tŷ-Mawr Expanded EcoCork - 20mm - 7.5m² per pack

40mm - 4m² per pack

60mm - 2.5m² per pack

80mm - 2m² per pack

100mm - 1.5m² per pack

120mm - 1m² per pack

140mm - 1m² per pack

160mm - 1m² per pack

See our quantity calculator on www.lime.org.uk for assistance with calculating the quantity as well as the type of materials you may require.

Protection of Work

Please refer to full application guides, material technical data sheets and material safety data sheets for protection of work guidelines.

Storage

For storage guidelines please refer to full application guides, material technical data sheets and material safety data sheets for protection of work guidelines.

After Care

Your finished lime plaster will care for your building for years to come as well as helping to control the humidity of the internal environment. It gives a beautiful finish that no modern plaster can replicate. We highly recommend that you finish it with a vapour permeable and preferably a natural paint, your choice will depend on the level durability vapour control and required aesthetic.

For further information about the whole subject and illustrated diagrams of lime plastering and pointing techniques, see The Lime Handbook now available to order on www.lime.org.uk

Health and Safety Information



Warning

Skin Irritation 2 H315 - Causes skin irritation

STOT SE 3 H335 - May cause respiratory problems



Danger

Eye Damage 1 H318 - Causes serious eye damage

Precautionary Statements

P102 Keep out of reach of children

P280 Wear protective gloves, eye protection/face mask.

P305 + P351 + P310 If in eyes rinse cautiously with water for several minutes and immediately get medical assistance.

P352 + P352 If on skin, wash affected area part immediately with plenty of soap and water.