



Gutex Woodfibre board

Tŷ-Mawr's LABC Registered external wall insulation system

Tŷ-Mawr's new external wall insulation systems are part of our innovative new range of LABC registered sustainable building solutions. In addition to their thermal and acoustic performance, their vapour permeability properties helps them to regulate humidity within the building contributing to a more comfortable and healthy living environment. These systems are ideal for the

refurbishment of existing solid external walls as well as cavity walls (care should be taken to ensure the cavity is shut off or filled, seek professional guidance).

The Tŷ-Mawr registered systems offer a choice of high quality, ecological and sustainable insulation materials, see table below.

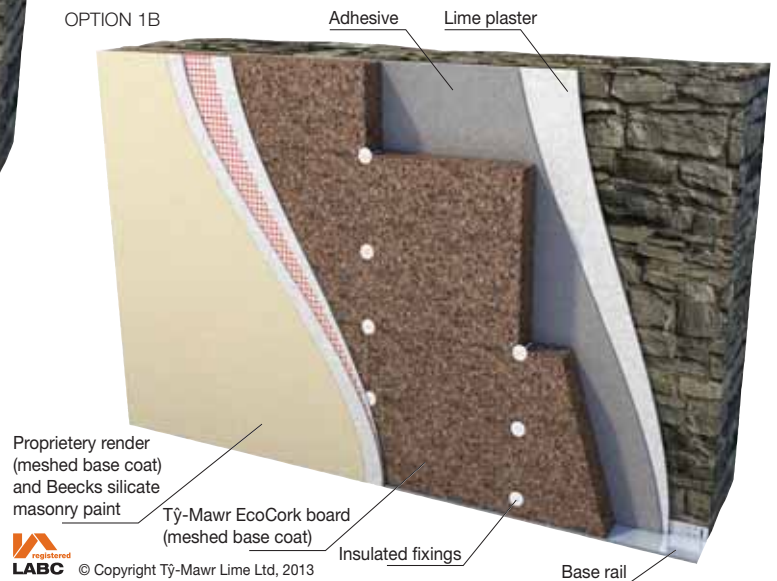
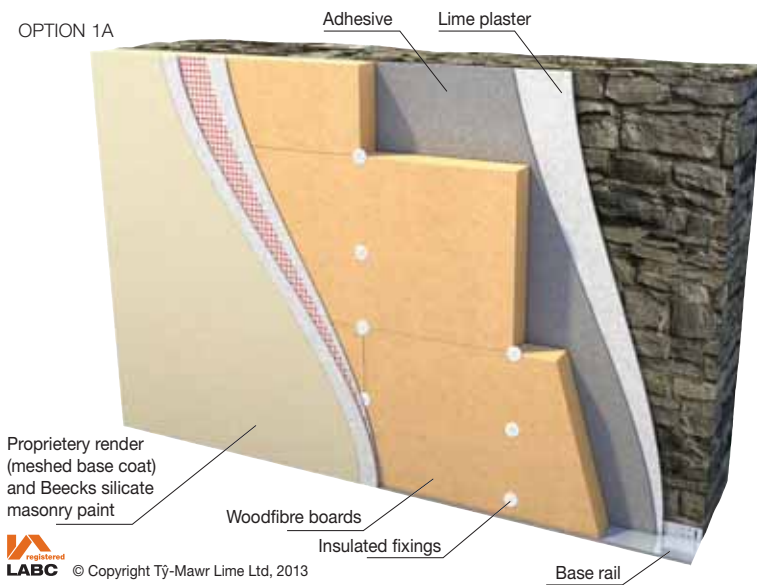

500-600mm Solid Wall	
Options 1A / 1B	Option 2
Approx 15mm levelling coat of Hydraulic Lime Plaster*	75mm of Insulation between studs chosen from below
Adhesive coat 8mm combed	Tŷ-Mawr Thermafleece Original/Ecoroll/TF35/Hemp, Holzflex mais, Flex CL Recycled paper
a) Woodfibre board 120mm (meshed base coat) fixed with insulated anchors at 8 per m ² b) Tŷ-Mawr EcoCork board 120mm (meshed base coat) adhered to masonry and fixed with insulated fixings	Woodfibre T&G board 60mm and approved washer fixings at 8 per m ²
Board manufacturers proprietary render system following manufacturers instructions or Tŷ-Mawr Hydraulic lime render 2 x 9mm coats	
Vapour permeable paint finish - Silicate masonry paint, Tŷ-Mawr limewash	
*as specified by Tŷ-Mawr Ltd. Please note different insulation thicknesses are available if there is not a Building Regulations requirement	

Contact us for u-value calculations, condensation risk analysis and quotations. Please note that LABC registered detail only applies where Tŷ-Mawr has designed the build-up (free of charge) and supplied the materials.



Tŷ-Mawr's LABC Registered
external wall insulation system

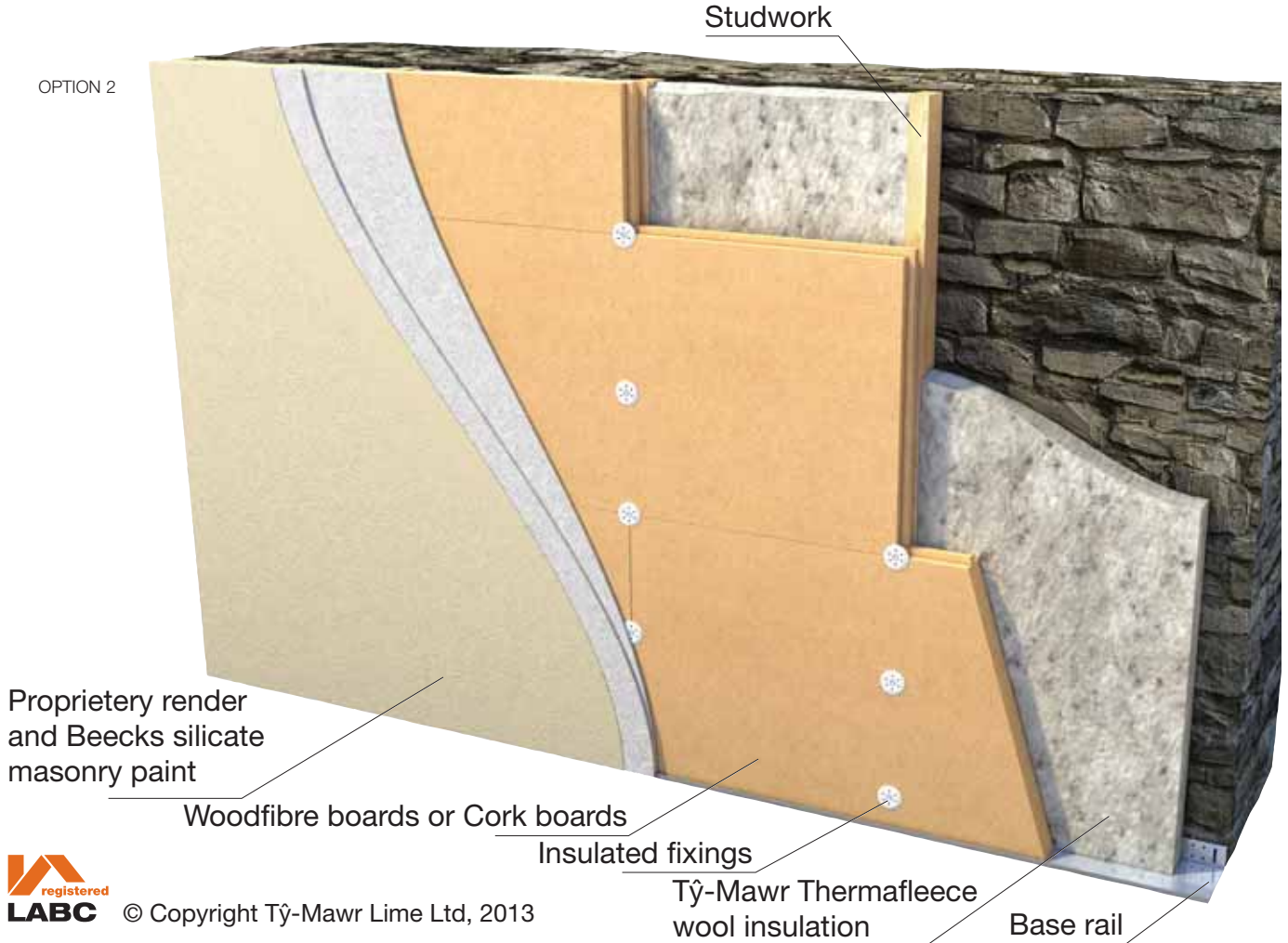

© Copyright Tŷ-Mawr Lime Ltd, 2013

500-600mm Solid Wall	
Options 1A / 1B	Option 2
Approx 15mm levelling coat of Hydraulic Lime Plaster*	75mm of Insulation between studs chosen from below
Adhesive coat 8mm combed	Tŷ-Mawr Thermafleece Original/Ecoroll/TF35/Hemp, Holzflex mais, Flex CL Recycled paper
a) Woodfibre board 120mm (meshed base coat) fixed with insulated anchors at 8 per m2 b) Tŷ-Mawr EcoCork board 120mm (meshed base coat) adhered to masonry and fixed with insulated fixings	Woodfibre T&G board 60mm and approved washer fixings at 8 per m2
Board manufacturers proprietary render system following manufacturers instructions or Tŷ-Mawr Hydraulic lime render 2 x 9mm coats	
Vapour permeable paint finish - Silicate masonry paint, Tŷ-Mawr limewash	
*as specified by Tŷ-Mawr Ltd. Please note different insulation thicknesses are available if there is not a Building Regulations requirement	

Contact us for u-value calculations, condensation risk analysis and quotations. Please note that LABC registered detail only applies where Tŷ-Mawr has designed the build-up (free of charge) and supplied the materials.

© Copyright - please do not infringe our copyright by copying or reproducing any part of this document.

Disclaimer - no responsibility can be accepted for any errors or omissions or any loss or damage as a result of using the information provided in these guidelines.

Units 5 & 12, Brecon Enterprise Park, Brecon, Powys LD3 8BT
 Tel: 01874 611350 Fax: 01874 622774
 Email: tymawr@lime.org.uk www.lime.org.uk



Tŷ-Mawr