



Distribution warehouse:
Unit 12, Brecon Enterprise Park,
Brecon, Powys LD3 8BT
Tel: 01874 611350 Fax: 01874 622774

North Wales office:
Betws-y-Coed,
Conwy.
Tel: 01690 710117 Fax: 01690 710201

Head office:
Tŷ-Mawr, Llangasty, Brecon,
Powys LD3 7PJ
Tel: 01874 658000 Fax: 01874 658502

FIXING DETAIL WOOD WOOL BOARDS

Boards should be mechanically fixed as per illustration using stainless steel screws and plastic fixing washers (available from Ty-Mawr). Please note the washers must be used to prevent movement and to successfully carry the plaster.

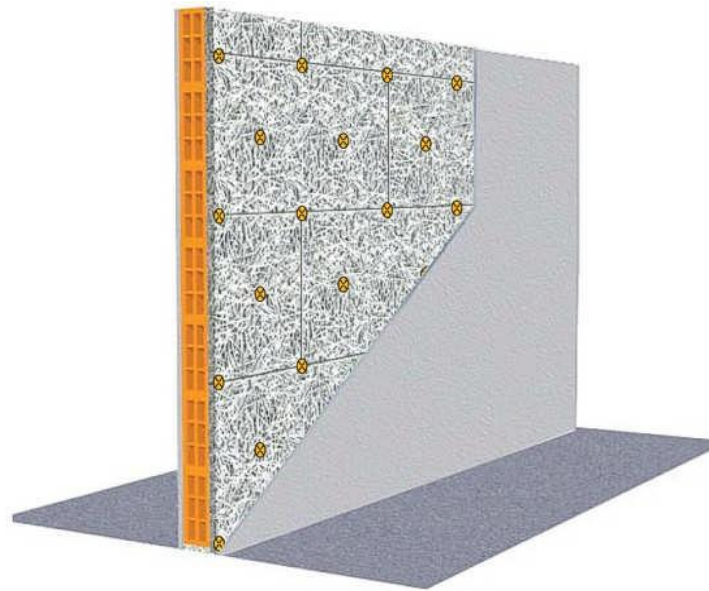

Cutting, Storing and Use

The panels can be cut either with a handsaw or a circular saw, they can then be stored in the open if necessary. They must, however, be used dry and laid close to one another, pressing slightly, and with staggered joints.

It is advisable to acclimatise the panels to room temperature by opening the stacks of panels and keeping them in the room for a few days before laying them. In the case of false ceilings and facings, keep some openings in order to balance the thermal- hygrometric state of both sides of the panels. Avoid overheating immediately after fitting the panels.

The surface on which the panels are to be fixed (walls and floorings) must be flat and be able to carry a certain amount of weight. The panels can be applied both internally and externally (25mm & 50mm only), using 8 fixings per square meter which, in the case of plastic fixings, penetrate the support by 50mm and, in the case of metal fixings, by 30mm.

The size of the battens and the distance between them can be found in the table below.

Panels thickness	Laths	Intervening Distance	
		In walls	In ceilings
mm	mm	mm	mm
15	50x30	400	n/a
25	50x30	600	400
50	60x40	1000	670

Please note : for a successful installation, we strongly recommend that our glaster or lime plaster products are used according to the technical guidelines provided with the plasters.

No responsibility can be accepted for any failures where Ty-Mawr has not supplied the full system.