



Courtesy: S.Frost

# Tŷ-Mawr's LABC Registered internal wall insulation system

Tŷ-Mawr's internal wall insulation systems are part of our innovative new range of LABC registered sustainable building solutions. In addition to their thermal and acoustic performance, their vapour permeability properties helps them to regulate humidity within the building contributing to a more comfortable and healthy living environment.

These systems are ideal for the refurbishment of existing

solid walls as well as cavity walls. Where internal space is limited or it is not possible to meet building regulations, lime hemp plaster can be applied directly to the walls to add some thermal insulation and assist with air tightness, please contact us for an information sheet.

The Tŷ-Mawr registered systems offer a choice of high quality, ecological and sustainable insulation materials, see 4 different options in table below.

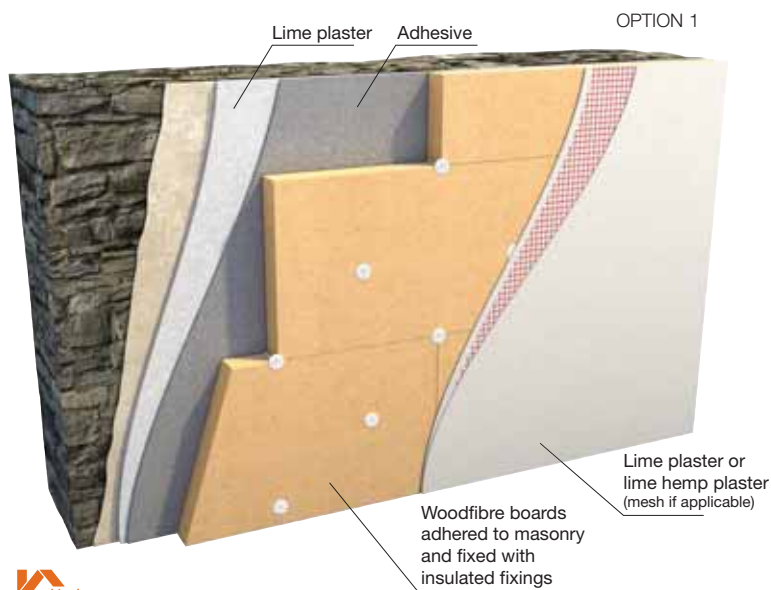

LABC © Copyright Tŷ-Mawr Lime Ltd, 2013

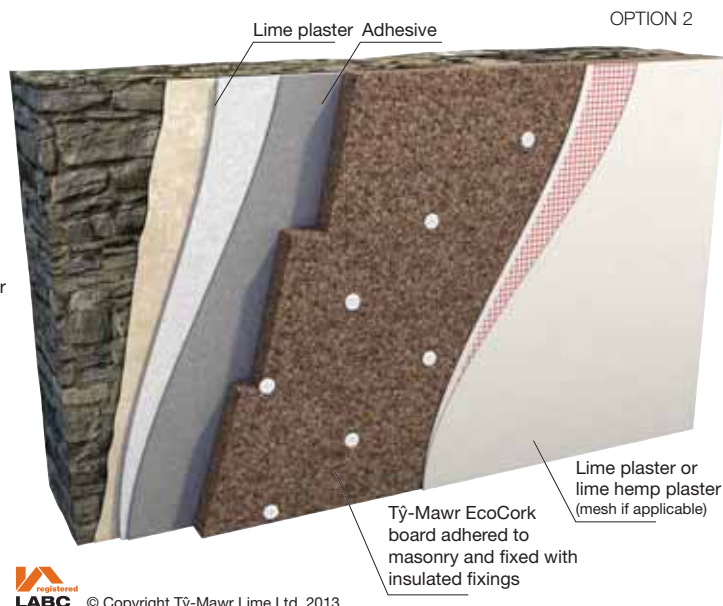

LABC © Copyright Tŷ-Mawr Lime Ltd, 2013

500mm Solid Wall (appropriate external protection from driving rain is essential when undertaking internal wall insulation – please contact us for advice)			
Minimum 20mm hydraulic lime plaster		Breather Membrane	
Option 1	Option 2	Option 3	Option 4
Adhesive 10mm combed coat	Adhesive 10mm combed coat	125mm of insulation chosen from below	100mm of insulation chosen from below
100mm Woodfibre board	100mm Eco-Cork board	Tŷ-Mawr Thermafleecce Original/Ecoroll/TF35/Hemp, Holzflex mais, Flex CL Recycled paper	
		Moisture variable vapour check if required	
		Tŷ-Mawr 15mm Wood Wool board fixed with plastic washers and screws at 8 per m <sup>2</sup>	Woodfibre board T&G 40mm fixed with plastic washers and screws at 8 per m <sup>2</sup>
Tŷ-Mawr Basecoat for Boards 1 x 6mm meshed basecoat (or lime hemp) and 1 x 3mm Premixed Topcoat plaster			
Vapour permeable Paint Finish - Internal Silicate Paint, Plant-based Emulsion, Tŷ-Mawr Limewash, Clay Paint			

Contact us for u-value calculations, condensation risk analysis and quotations. Please note that LABC registered detail only applies where Tŷ-Mawr has designed the build-up (free of charge) and supplied the materials.



# Tŷ-Mawr's LABC Registered internal wall insulation system

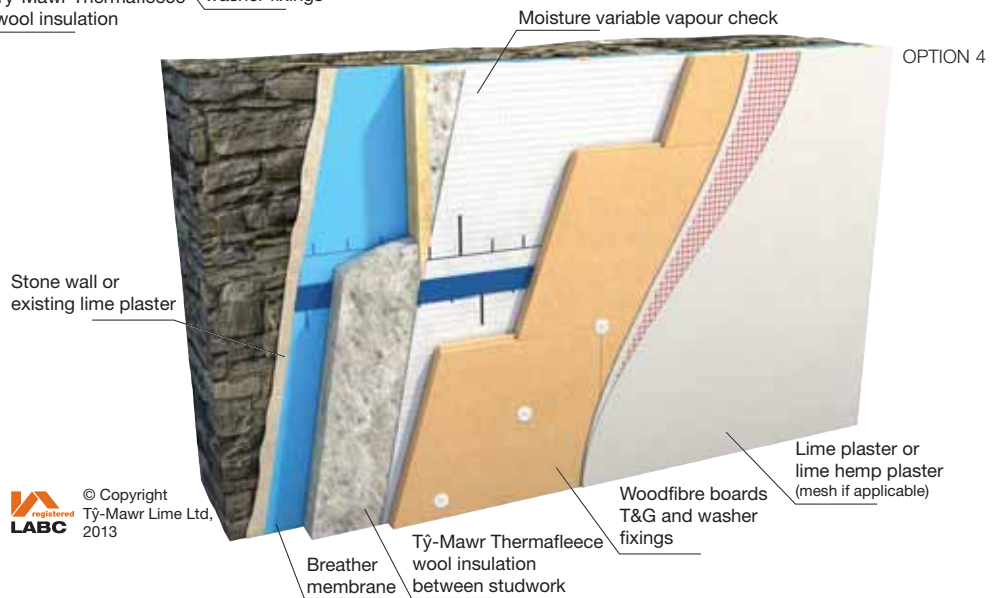
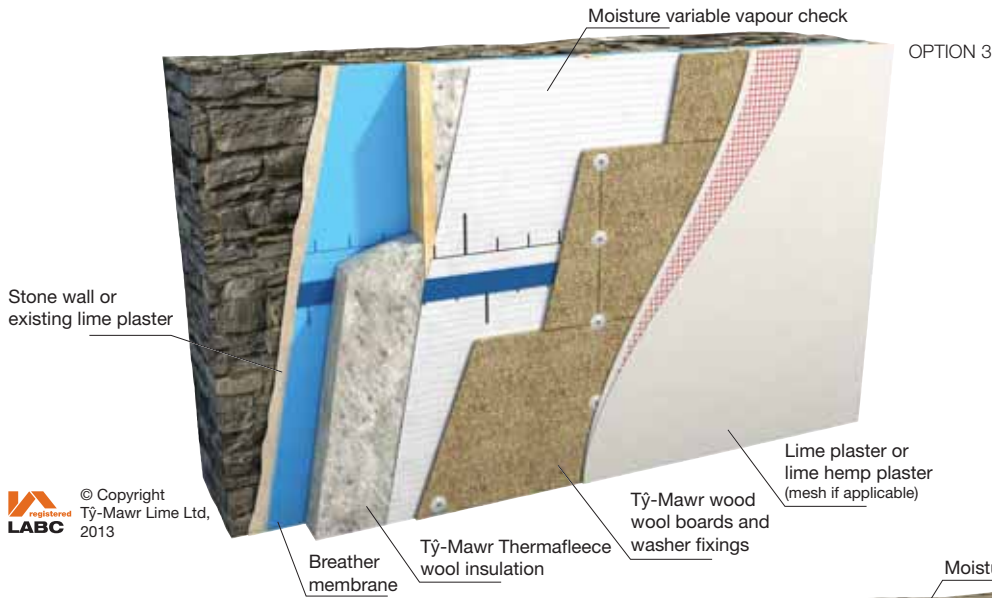

500mm Solid Wall (appropriate external protection from driving rain is essential when undertaking internal wall insulation – please contact us for advice)			
Minimum 20mm hydraulic lime plaster		Breather Membrane	
Option 1	Option 2	Option 3	Option 4
Adhesive 10mm combed coat	Adhesive 10mm combed coat	125mm of insulation chosen from below	100mm of insulation chosen from below
100mm Woodfibre board	100mm Eco-Cork board	Ty-Mawr Thermafleece Original/Ecoroll/TF35/Hemp, Holzflex mais, Flex CL Recycled paper	
		Moisture variable vapour check if required	
		Ty-Mawr 15mm Wood Wool board fixed with plastic washers and screws at 8 per m <sup>2</sup>	Woodfibre board T&G 40mm fixed with plastic washers and screws at 8 per m <sup>2</sup>
Ty-Mawr Basecoat for Boards 1 x 6mm meshed basecoat (or lime hemp) and 1 x 3mm Premixed Topcoat plaster			
Vapour permeable Paint Finish - Internal Silicate Paint, Plant-based Emulsion, Ty-Mawr Limewash, Clay Paint			

Contact us for u-value calculations, condensation risk analysis and quotations. Please note that LABC registered detail only applies where Ty-Mawr has designed the build-up (free of charge) and supplied the materials.

© Copyright - please do not infringe our copyright by copying or reproducing any part of this document.

Disclaimer - no responsibility can be accepted for any errors or omissions or any loss or damage as a result of using the information provided in these guidelines.

Distribution warehouse: Unit 12, Brecon Enterprise Park,  
Brecon, Powys LD3 8BT Tel: 01874 611350 Fax: 01874 658502  
Email: tymawr@lime.org.uk www.lime.org.uk



## Ty-Mawr